



Model FDC2

Fire Department Connections

Application

Zurn FDC2 Fire Department Connections provide a means for firefighters to connect hose lines to a fire sprinkler system to supplement the domestic water supply. This ensures active fire protection systems have an adequate water supply. The FDC2 has two swivel inlet connections separated by a single clapper that acts as a check valve against backflow if only one hose is attached. The FDC2 is available in straight and 90 degree body styles.

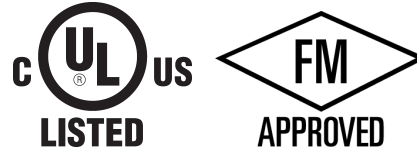

Standards Compliance

- UL ® Listed
- C-UL ® Listed
- FM® Approved

Materials

Casting Brass
Gaskets EPDM

Features

Maximum Pressure: 300 PSI
Standpipe Connection 4" NPT
Siamese Inlet Connections 2 X 2-1/2"



4X212-FDC2-EX-SC



4X212-FDC2-EX90-SC

Dimensions & Weights (do not include pkg.)

Dimensions are shown as inches

Weight 7.5 lb.

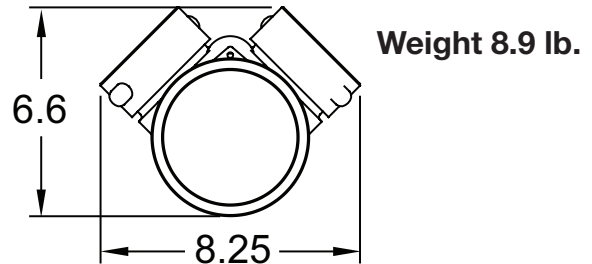
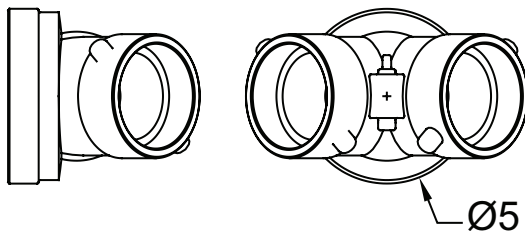
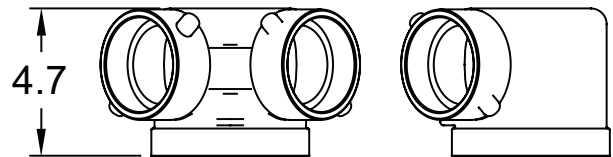
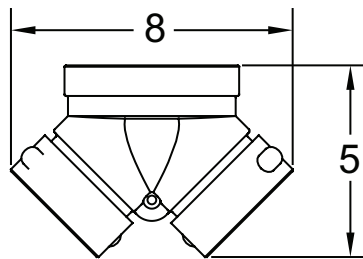

Weight 8.9 lb.